

# FRIGIDAIRE

GALLERY.



## French Door Refrigerator

FGHF2369MF

23 Cu. Ft. Counter-Depth



### Signature Features



#### Adjustable Interior Storage

Over 100 ways to organize and customize your refrigerator.



#### Best-in-Class Ice & Water Filtration<sup>1</sup>

PureSource Ultra<sup>®</sup> Water Filtration offers best-in-class water filtration so you get cleaner, fresher ice and water for your family.



#### Smudge-Proof<sup>™</sup> Stainless Steel

Reduces fingerprints and smudges so it's easy to clean.



#### Counter-Depth Design

Maximize your kitchen space with our counter-depth refrigerator that gives you back 5 inches of kitchen space while still offering over 100 ways to organize.

### Product Dimensions

Height (Including Hinges & Rollers)	69-7/8"
Width (Doors)	36"
Depth (Including Door)	28-1/2"

### More Easy-To-Use Features

#### Full-Width Cool Zone<sup>™</sup> Drawer

A large capacity Cool Zone<sup>™</sup> Drawer extends completely and provides space to easily store anything from sheet cakes and large platters to snacks and juice boxes.

#### Freezer Basket with Divider

Deep freezer storage with adjustable divider keeps food organized and accessible.

#### Designer LED Lighting

Beautiful, ramp-up lighting keeps contents clearly visible.

#### Quick Freeze

Quickly freeze foods so they stay at their freshest.

#### Effortless<sup>™</sup> Glide Crisper Drawers

Our humidity-controlled crisper drawers can be configured any number of ways, either side-by-side or stacked on top of each other so you can organize your refrigerator the way you want, while keeping your fruits and vegetables fresh.

#### Effortless<sup>™</sup> Glide Freezer Drawers

Drawers glide out smoothly and fully extend, giving you easy access to what's inside.

#### Store-More<sup>™</sup> Bins

Our gallon-size bins are designed to store more, so you can fit a gallon of milk.

#### SpillSafe<sup>®</sup> Glass Shelves

SpillSafe<sup>®</sup> Glass Shelves slide out for easy access and are designed to keep spills contained, making cleanup a breeze.

ENERGY STAR<sup>®</sup>

Sabbath Mode (Star-K<sup>®</sup> Certified)



Available in:



Stainless (F)

<sup>1</sup>As compared to other consumer refrigeration water filtration systems.

frigidaire.ca

Features	
Door Design	Soft-Arc Doors
Door Handle Design	Stainless Steel
Cabinet Finish	Grey
Door Stops / Door Closers	Yes / Yes
Door Hinge Covers	Hidden
Rollers - Front / Rear	Adjustable / Yes
Energy Saver Plus Technology	Yes
Water Filter Location	Top-Right Fresh Food Section
Sound Package	Quiet Pack
Dispenser	
Controls	Express-Select®
Dispenser Design	Tall, Single-Paddle
Number of Dispenser Buttons	13
Crushed Ice / Cube Ice / Chilled Water	Yes / Yes / Yes
Ice Option / Freeze Option	No / Quick Freeze
Display On / Off Option	Yes
Lock / Light	Yes / Yes
Temp / Door Ajar / Power Failure Alerts	Yes / Yes / Yes
Water Filter Change Indicator Light	Yes
Air Filter Change Indicator Light	Yes
Refrigerator Features	
Lighting	Designer LED
Water Filter Type	PureSource Ultra®
Air Filter Type	PureAir Ultra®
Fixed Shelves	
Quarter-Width Sliding Shelves	1 SpillSafe®
Half-Width Sliding Shelves	3 SpillSafe®
Cantilever Shelves	Yes
Store-More™ Full-Width Drawer	1 Cool Zone™
Hanging Wine Rack	1 Clear
Hanging Can Dispenser	
Crisper Drawer	2 Clear
Humidity Controls	2
Dairy Compartment	1 Clear
Store-More™ Fixed Door Bins	2 White (1 per door)
Fixed Door Bins	1 Half-Gallon / 2-Litre Clear
Adjustable Door Bins / Dispenser Bin	1 Two-Gallon Clear / 1 Clear
Non-Slip Bin Liner / Bottle Retainers	No / 1
Freezer Features	
Self-Closing Pull-Out Drawer	Yes
Sliding Full-Width Freezer Baskets	2 Effortless™ Glide
Basket Dividers	1 (Bottom Basket)
Lighting	Yes
Certifications	
Sabbath Mode (Star-K® Certified)	Yes
ENERGY STAR®	Yes
Specifications	
Total Capacity (Cu. Ft.)	22.6
Refrigerator Capacity (Cu. Ft.)	15.69
Freezer Capacity (Cu. Ft.)	6.88
Power Supply Connection Location	Right Bottom Rear
Water Inlet Connection Location	Left Bottom Rear
Voltage Rating	120V / 60Hz / 15 or 20A
Connected Load (kW rating) @ 120 Volts¹	1.02
Amps @ 120 Volts	8.5
Minimum Circuit Required (Amps)	15
Shipping Weight (Approx.)	350 Lbs.

<sup>1</sup>For use on adequately wired 120V, dedicated circuit having 2-wire service with a separate ground wire. Appliance must be grounded for safe operation.

### Standard Refrigerator Depth vs. Counter Depth

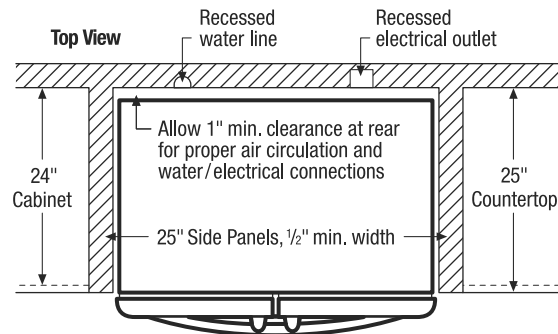
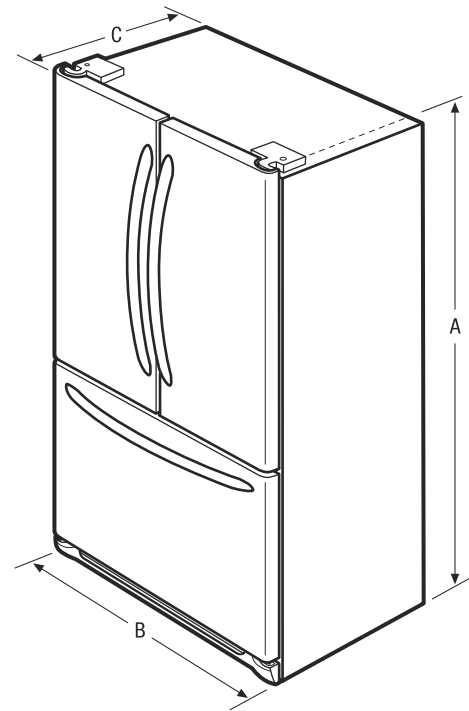
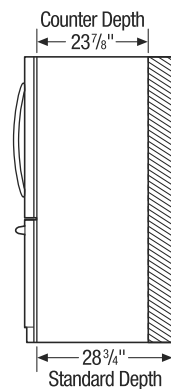

NOTE: For planning purposes only. Always consult local and national electric and plumbing codes. Refer to Product Installation Guide for detailed installation instructions on the web at [frigidaire.ca](http://frigidaire.ca).



Product Dimensions	
A- Height (Incl. Hinges & Rollers)	69-7/8"
B- Cabinet Width / Door Width	35-7/8" / 36"
C- Depth (Incl. Door)	28-1/2"
Depth with Door Open 90°	42-1/2"
Depth with Drawer Fully Extended (Incl. Handle)	45-1/2"

"Built-In Look" Cutout Dimensions	
Height (Incl. Hinges and Rollers)	70-1/4"
Width	36"
Depth	25"

Accessories information available on the web at [frigidaire.ca](http://frigidaire.ca)